

## RB3245

Nippel reduziert mit A Gewinde.

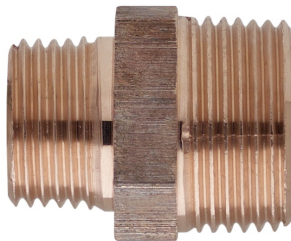

### Technische Spezifikationen

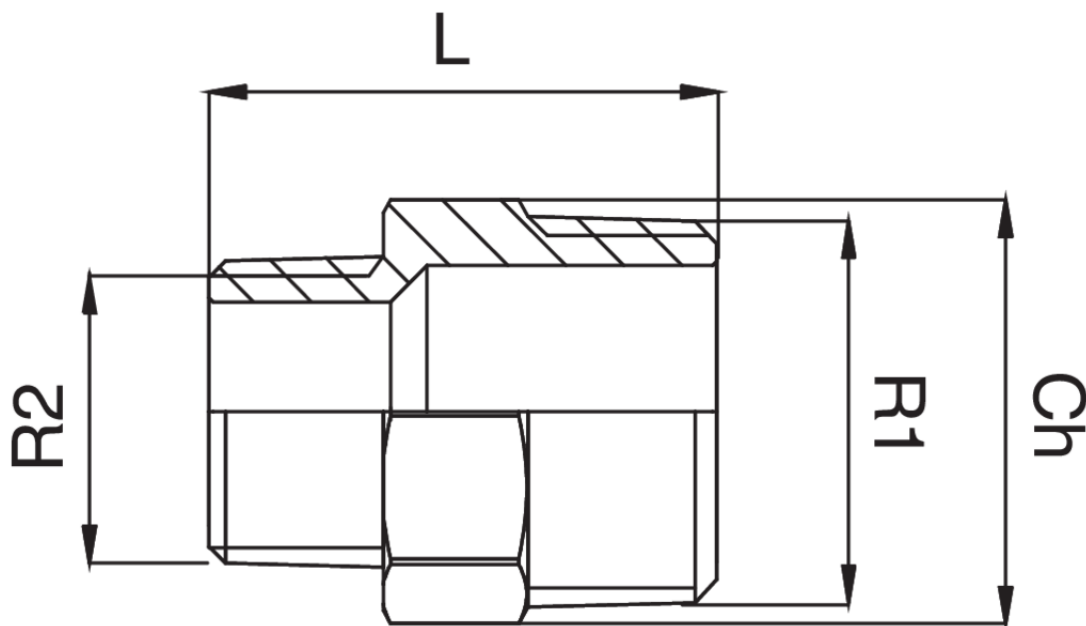

| R1 X R2       | BAG | MASTER BOX | CODE            | CH | L  |
|---------------|-----|------------|-----------------|----|----|
| 1/2" x 3/8"   | 10  | 300        | RB3245A12A38000 | 21 | 28 |
| 3/4" x 1/2"   | 10  | 150        | RB3245A34A12000 | 27 | 33 |
| 1" x 1/2"     | 10  | 100        | RB3245B01A12000 | 34 | 37 |
| 1" x 3/4"     | 10  | 100        | RB3245B01A34000 | 34 | 38 |
| 1"1/4 x 3/4"  | 1   | 40         | RB3245B14A34000 | 42 | 41 |
| 1"1/4 x 1"    | 5   | 40         | RB3245B14B01000 | 42 | 43 |
| 1"1/2 x 1"    | 5   | 40         | RB3245B12B01000 | 48 | 45 |
| 1"1/2 x 1"1/4 | 5   | 40         | RB3245B12B14000 | 48 | 47 |
| 2" x 1"1/2    | 5   | 20         | RB3245C02B12000 | 60 | 55 |

# Anwendungen



DRINKING WATER



HEATING



HVAC



GAS



COMPRESSED AIR



SOLAR



FIREFIGHTING