

Té F/F/F en cuivre.

## Spécifications techniques

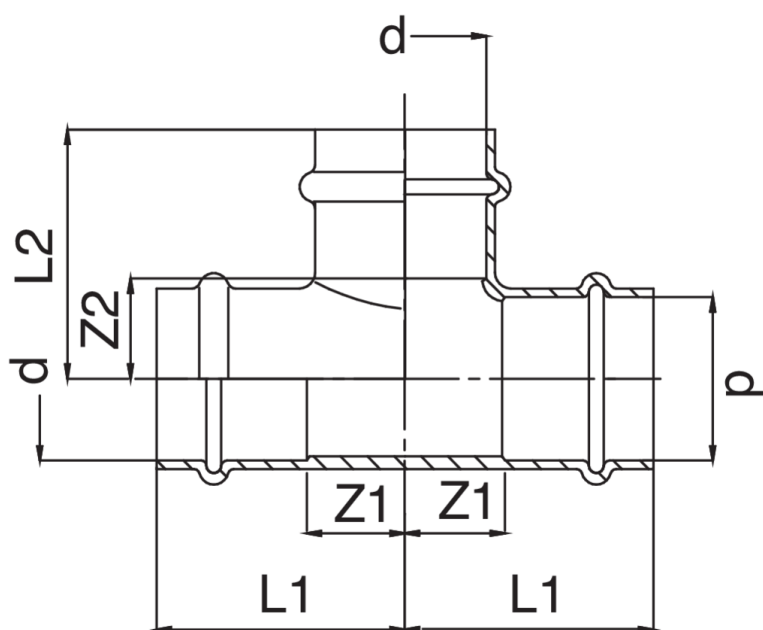

D	BAG	MASTER BOX	CODE	L1	L2	Z1	Z2
15	10	100	HT9130015015015	41	33	19	11
18	5	50	HT9130018018018	42	35	19	12
22	5	40	HT9130022022022	45	39	21	15
28	5	35	HT9130028028028	48	46	23	21
35	5	20	HT9130035035035	53	48	27	22

# Applications



SOLAR



STEAM



COMPRESSED  
AIR



INDUSTRIAL