

Raccord avec écrou en laiton F/filetage femelle.

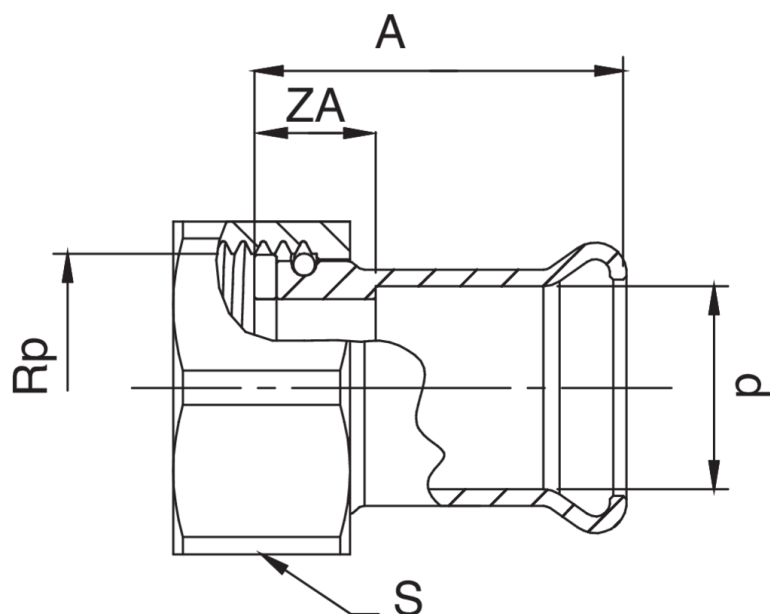

## Spécifications techniques



| D X RP     | BAG | MASTER BOX | CODE            | A    | S  | ZA   |
|------------|-----|------------|-----------------|------|----|------|
| 15 x 1/2"  | 10  | 50         | MXF359A12015000 | 40   | 24 | 20,5 |
| 15 x 3/4"  | 10  | 100        | MXF359A34015000 | 28   | 30 | 8,5  |
| 18 x 3/4"  | 5   | 100        | MXF359A34018000 | 32   | 30 | 12,5 |
| 22 x 3/4"  | 5   | 50         | MXF359A34022000 | 47   | 30 | 24,5 |
| 22 x 1"    | 5   | 100        | MXF359B01022000 | 34   | 37 | 11,5 |
| 28 x 1"    | 5   | 80         | MXF359B01028000 | 48,5 | 37 | 22   |
| 28 x 1"1/4 | 10  | 50         | MXF359B14028000 | 34,5 | 47 | 8,5  |
| 35 x 1"1/4 | 5   | 60         | MXF359B14035000 | 56,5 | 47 | 27   |
| 35 x 1"1/2 | 5   | 20         | MXF359B12035000 | 38   | 52 | 8,5  |
| 42 x 1"1/2 | 2   | 54         | MXF359B12042000 | 61   | 52 | 30   |
| 42 x 1"3/4 | 2   | 50         | MXF359B34042000 | 40   | 60 | 30   |
| 54 x 2"    | 2   | 30         | MXF359C02054000 | 71,5 | 64 | 35   |
| 54 x 2"3/8 | 1   | 10         | MXF359C38054000 | 47   | 75 | 12,5 |

## Applications



DRINKING  
WATER



HEATING



HVAC



COMPRESSED  
AIR



FIREFIGHTING



MARINE



STEAM



SOLAR



INDUSTRIAL